

Digital innovations from Baumat AG for precast concrete element production

Since 1896, Baumat AG stands for quality and reliability in the construction industry. The family-run company, headquartered in Wichtrach with six other locations in the canton of Bern, offers a comprehensive range of building materials. Baumat AG also specialises in customised reinforcement steel and the production of made-to-measure concrete elements – from staircases and façade elements to individual custom-made products. With the slogan “you build – we deliver”, Baumat AG and its approximately 200 employees support their customers in carrying out construction work on time and to a high standard. It does this with a wide range of products and appropriate consulting and planning services. With the ahead software solution, Baumat AG is relying on a holistic solution to make precast concrete element production more transparent, traceable and predictable.

The ahead software as a comprehensive platform

The prefabrication of concrete elements has grown significantly in recent years. However, the increasing number of elements could no longer be mapped using the previous Excel planning system. The aim was to replace the previous Excel-based processes with modern software that could be

gradually integrated into ongoing operations and remain compatible with the ERP system and 3D modelling. The decision was made to use the ahead software from the Progress Group's software portfolio. The implementation focused on mapping and integrating all relevant areas – production, quality, planning and logistics.

A core team of five employees coordinated the project, while around 40 employees used ahead along the entire value chain; during the changeover, two systems were used in parallel and individual processes were gradually migrated to ahead, accompanied by comprehensive training. “Since we wanted to put ahead into productive use as quickly as possible, certain development steps and adjustments were carried out only after the go-live,” reports the management. ahead was introduced as a central platform and connects production, quality assurance, planning and logistics. Order processing is now much more transparent and consistent, partly due to the connection to existing software solutions in the areas of 3D modelling software and ERP system. This applies in both directions: from order entry in the ERP system to transfer to ahead and feedback of the finished concrete elements to the ERP system. This gives Baumat a real-time display of the order status.



All concrete elements are custom-made according to customer specifications.



Baumat AG offers a full range of products at seven locations in the canton of Bern, Switzerland.

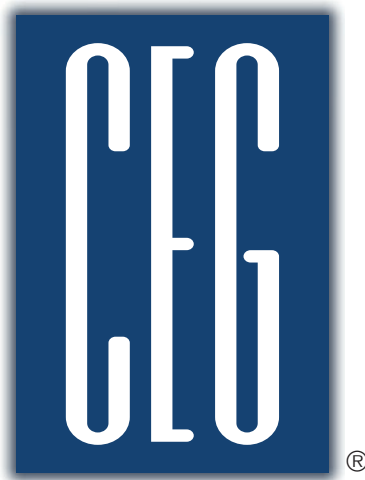

®

THE CONSULTING ENGINEERS GROUP INC.®

www.cegengineers.com
larbi@cegengineers.com
T +(1) 210-872-8155

Precast and Prestressed concrete design, engineering and detailing services from conception to service, a company specializing in Precast concrete since 1967.

making all the

PIECES FIT

Architects . Engineers . Parking Consultants

Offices

Chicago, IL San Antonio, TX Dallas, TX Orlando, FL Murrieta, CA Albuquerque, NM
Manila, Philippines Seoul, Korea Istanbul, Turkey Hanoi, Vietnam Cancun, Mexico
Tokyo, Japan

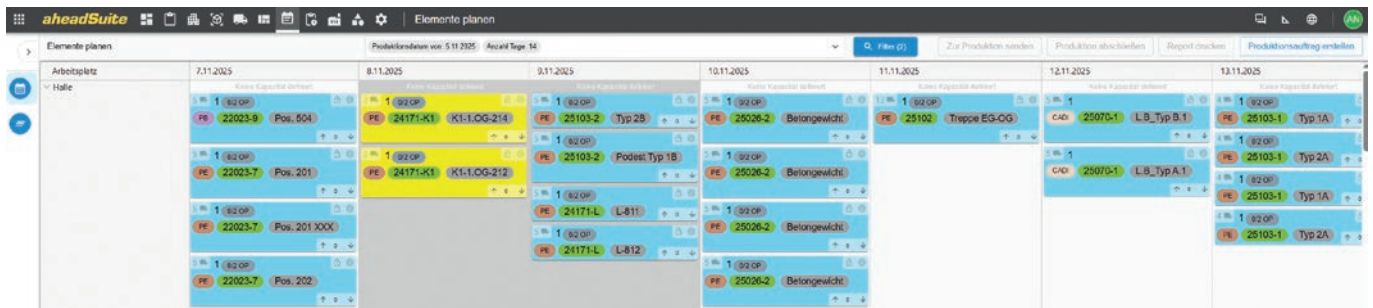

The ahead software is used for production planning, where it increases efficiency and flexibility.

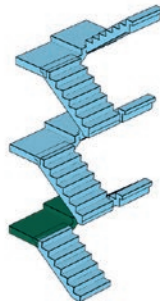
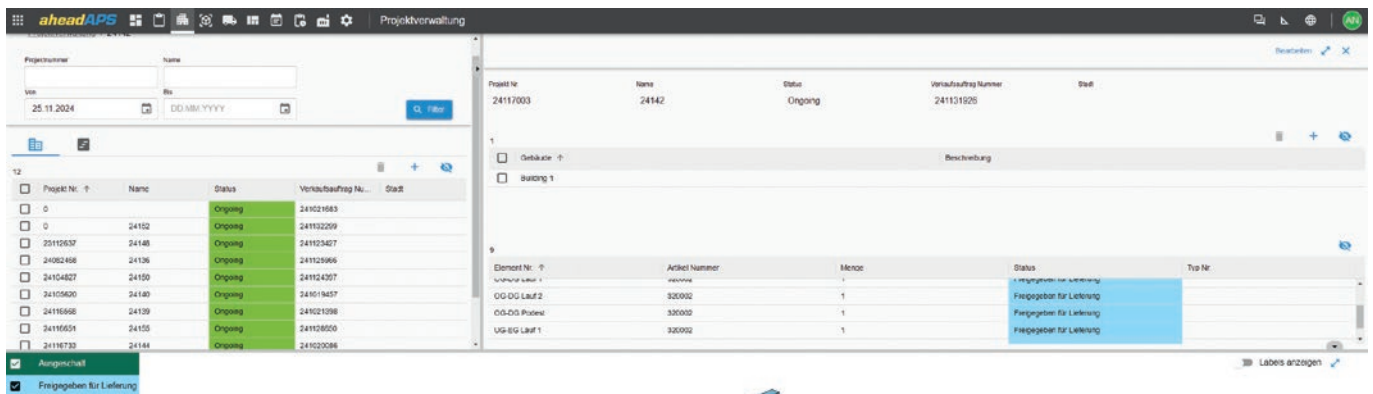

Around 40 employees use ahead along the entire value chain at Baumat.



The newly installed collection trolley on the ESR straightening and cutting machine optimises logistics in reinforcement processing.

Even after the go-live, the project team continued to provide a high level of support. The management states: "The collaboration with the Progress project team was and continues to be excellent. I have rarely experienced such constructive and efficient cooperation within a software project."

Transparency and process proximity

"Ahead makes order processing much more transparent; every step can be tracked in real time, from order acceptance to delivery." This takes quality assurance and traceability of individual process steps to a whole new level. In ahead, every step can be documented, controlled and tracked – not only during production, but also after the elements have been delivered to the customer's construction site.

"Only an integrated, data-based solution running parallel to operational management can create true end-to-end transparency, traceability and the necessary flexibility," says the management, summarising the advantages.

Strong partnership and a look to the future

Baumat already has a long-standing partnership with the Progress Group as a technology supplier in the field of reinforcement production. An EBA automatic stirrup bending machine and an ESR straightening and cutting machine are in use on site. A newly installed collection trolley also optimises the processes in logistics and the onward transport of the reinforcement. The latest investments in targeted software implementation, supported by partners, have strengthened processes and made them future proof. The path to a holistic digitalisation strategy involves connecting a scheduling tool and warehouse management system and gradually expanding the use of ahead to other sub-processes in production.



PROGRESS GROUP sponsored the free download possibility of the pdf of this article for all readers of CPI. Please check the website www.cpi-worldwide.com/channels/progress-group or scan the QR code with your smartphone to get direct access to this website.



FURTHER INFORMATION



Baumat AG
Thalgutstrasse 2
3114 Wichtrach, Switzerland
T +41 31 7801010
info@baumat.ch
www.baumat.ch



Progress Software Development GmbH
Julius-Durst-Straße 100
39042 Brixen, Italy
info@progress-psd.com
www.progress-psd.com

Progress Maschinen & Automation AG
Julius-Durst-Straße 100
39042 Brixen, Italy
info@progress-m.com
www.progress-m.com



PROGRESS GROUP

Straightening, cutting and bending

- Flexible
- Energy efficient
- Low maintenance

The MSR line with its innovative rotor straightening system enables numerous types of automation. It offers customized solutions for the processing of large wire diameters off coil.

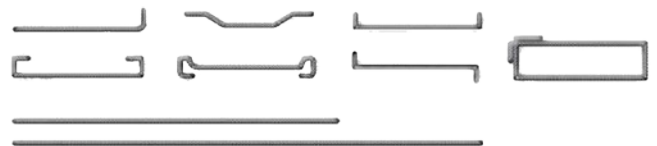

www.progress-m.com

