

Kraft Curing Systems GmbH, 49699 Lindern, Germany

Granulate dispenser for the fully automatic separation of concrete products layers

The separation of layers of concrete paving stones or patio slabs using materials such as lattice nets or fleece is often very elaborate and expensive, even more so if the materials require manual positioning which also presents a safety issue. Help is at hand in the form of the T-Rex™ granulate dispenser from Kraft Systems for the fully automatic separation of layers using recycled plastic granulate.



T-Rex granulate dosing unit from Kraft Systems

The T-Rex granulate dispenser is integrated in the production line on the dry-side between the stone squeezer and the cuber. As the cured concrete products on the conveyor pass under the granulate dispenser, T-Rex distributes a preset quantity of granules automatically and evenly over the products. As a result, the layers are separated from one another after stacking: the granulate works like lots of small spacers.

Light barriers detect the incoming products and trigger the dosing process. The T-Rex dispenser is operated by a Siemens S7 control unit (speed, granule distribution and dosage), which can normally be installed within a radius of 5 m of the T-Rex dispenser. The T-Rex from Kraft Systems requires little space – just 900 mm between the stone squeezer and the cuber – and can therefore easily be integrated, even in cramped conditions. T-Rex can be installed over a conveyor belt width of up to 1600 mm.

The granules are available in a rectangular or round form and consist of LDPE (polyethylene), which is recycled from packaging materials. It can be reused or, for example, also used as a fuel for energy production. Biogranules, which is self-degrading, can also be used as an alternative.

The advantages of the T-Rex granulate dosing unit

- **Protection of the surface**
The granulate reliably separates one layer of concrete products from the next. The layers are not in direct contact, therefore scratches and abrasion are avoided.

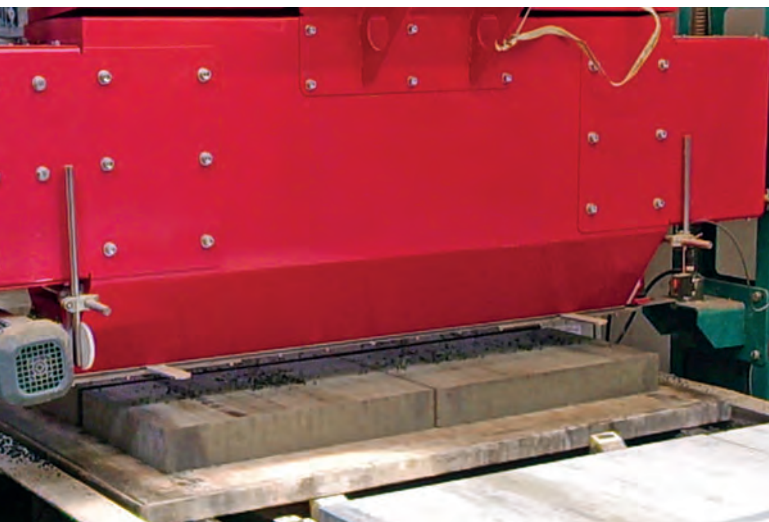

The T-Rex distributes a preset quantity of granulate over the products.

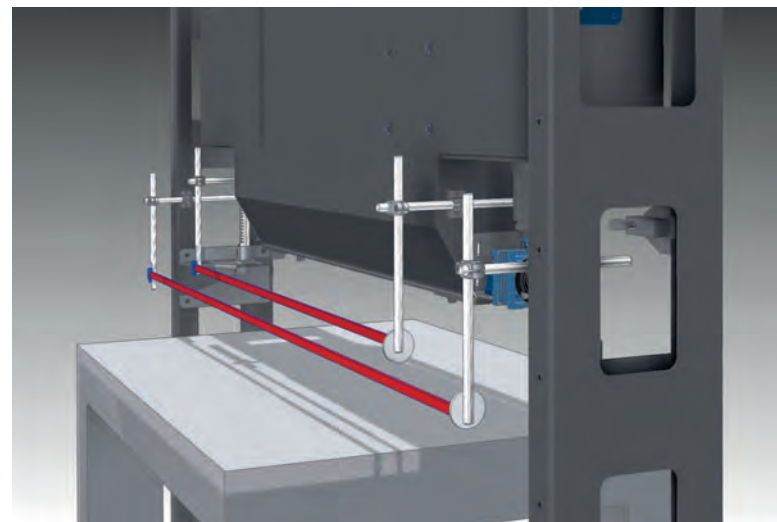

Light barriers detect the incoming products and trigger the dosing process



The granulate is available in a rectangular form and consists of LDPE (polyethylene), which is recycled from packaging materials

- Securing of the layer**
 The mechanically flexible LDPE granulate works like a rubber mat and secures the finished product against slipping or shifting.
- Prevention of efflorescence**
 The granulate maintains the distance between layers of finished concrete products and thus enables air to circulate between the layers. Moisture can escape and efflorescence and stains on the stones are prevented.
- Automatic operation**
 Once adjusted, the T-REX operates without human intervention. Electro-optic sensors detect both products and possible obstacles and ensure trouble-free operation.
- Inexpensive solution**
 The consumables, the lack of wearing parts and the automatic operation can make the T-Rex a useful and inexpensive investment for the protection of valuable concrete products.

The T-Rex granulate dispenser can be installed by the customer, or as a complete installation and commissioning by Kraft systems. ■

FURTHER INFORMATION



Kraft Curing Systems GmbH
 Muehlenberg 2
 49699 Lindern, Germany
 T +49 5957 96120
 F +49 5957 961210
info@kraftcuring.com
www.kraftcuring.com

QUADRIX

CONTROLLED CONCRETE CURING
 FOR HIGH QUALITY PAVERS, ROOF
 TILES, BLOCK AND MASONRY UNITS

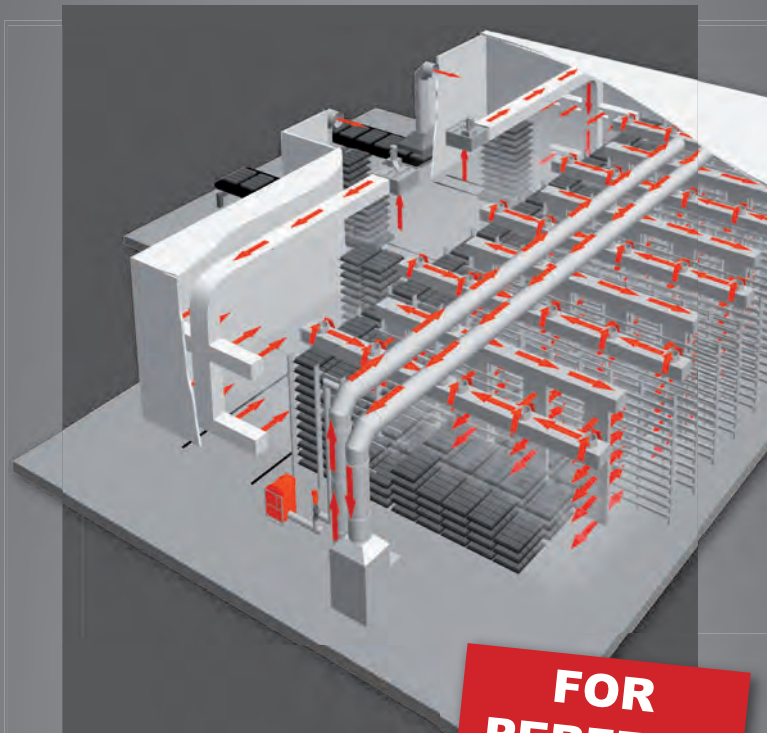

**FOR
 PERFECT
 RESULTS**



- ▶ Uniform, bright colors
- ▶ Denser surface, harder corners & edges
- ▶ High early strength
- ▶ Reduce cement costs
- ▶ Reduce efflorescence



Learn more by visiting
www.kraftcuring.com
 or scanning the QR code



CONCRETE CURING SOLUTIONS · MADE IN GERMANY

Kraft Curing Systems GmbH
 49699 Lindern, Germany
 Phone: +49-5957-961260

Kraft Curing Systems, Inc.
 Fairless Hills, PA 19030, USA
 Phone: +1-267-793-1005

www.kraftcuring.com · info@kraftcuring.com