

Masa GmbH, 56626 Andernach, Germany

# Fascination of the bauma – traditional company presented a large number of new and further developments

The trade fair appearance of the traditional German company Masa at the 31st world-leading fair for construction machines, building material machines, mining machines, construction vehicles and construction equipment in Munich once again offered lots of space for the presentation of technical innovations and expert discussions. The trade fair booth, which extended over two floors, impressed visitors even at first glance with monumental exhibits. Guests and friends from all over the world were welcomed on a total booth area of 740 m<sup>2</sup>.



Masa at the bauma 2016

Masa exhibited various plant components for the production of concrete blocks, sand lime bricks and AAC Products. The Masa HDP 800 sand lime brick press, e.g. left a lasting impression: with a height of 5.8 m and a weight of 36 t, the press was both the largest and heaviest exhibit at the Masa booth.

Three interactive beamer systems were used for the presentation of the Masa product range. These 100-inch projection screens were hugely popular on both levels

of the Masa booth. Their playful character paved the way for the visitor to quickly enter the Masa product world. Moving 3D views invited one to look into the details. With regard to the exhibits, the main attractions were the Masa XL 9.1 concrete block making machine, the Masa Cuboter and the Masa Splitter 1250.

### Masa XL 9.1 concrete block making machine

The XL 9.1 in particular packs quite a punch: In addition to well-known high-tech features, the near-series prototype exhibited sprang some surprises with the following new features/innovations:

#### Servo pump for main filling box with MLC controller (successor of Mac 8)

In this system, two axial piston pumps connected in series are driven by a synchronous servo motor. The pressure and volumetric flow rate are regulated by control of the speed and the adjustment of the pivot angle. Additional flow control valves are no more required with this system.

- Energy is recovered from the oil flowing out.
- No pressure drop at the flow control valves.
- Power consumption in standby mode is very low.
- There are only minimal losses due to less friction.
- Lower heat is generated, hence the cooling power is reduced.

Masa expects savings of 15-20% compared to conventional hydraulic systems.

#### Face mix concrete Filling box with driven base

The execution with a driven base ensures the optimum distribution/supply of coloured face mix concrete to the filling box. The filling box drives forward with the base closed; as it drives back again, the base opens and the mould is filled.

#### Magnetic compaction head lock

Permanent magnets are used in magnetic compaction head lock; they are energised only for the magnetisation and demagnetisation.



Visitors playfully gather information about the Masa product range



Visitors were able to observe a comparison of energy savings on a monitor



# masa

Milestone to your success.

## Thank you for your visit.

### Masa GmbH

Masa-Str. 2  
56626 Andernach  
Germany  
Phone +49 2632 9292 0  
Service Hotline +49 2632 9292 88

### Masa GmbH

**Werk Porta Westfalica**  
Osterkamp 2  
32457 Porta Westfalica  
Germany  
Phone +49 5731 680 0

### Masa Concrete Plants India Pvt. Ltd.

#5B, KIADB, Bommasandra Ind. Area  
Attibele, Bangalore 560 099  
India  
Phone +91 80 2628 3888  
Mail info@masa-india.com

info@masa-group.com  
service@masa-group.com  
www.masa-group.com

Masa - made in Germany.



sation. During operation, therefore, the magnets are de-energised and maintenance-free during operation.

**Vibrating table amplitude monitor**

Non-contact sensors are mounted underneath the vibrating table. These measure the amplitude of the vibrating table during production if necessary. This allows better planning of the manufacturing process and pending maintenance work.

A multi-colour system was presented above the Masa XL concrete block making machine: Coloured concrete is fed by rotatable dosing belts onto a mobile collection belt and transported to the face mix machine silo. The system allows reproducible colour repetitions at all times.



*Spectacularly staged – a multi-colour system was located above the Masa XL*

As the “highlight”, a face mix concrete mixer type S 350/500 was installed on the top platform of the Masa stand. This mixer is extremely well suited to the production of high-quality multi-colored face mix concrete products.

**Masa Cuboter**

The here exhibited Cuboter is distinguished by modern energy-saving servo technology. By DC link system and innovative robotic technology optimal flight curves (trajectories) can be realized. Thus, the cycle time is optimized and the installed capacity and energy consumption is reduced also it simplifies operation.

Interesting for the visitors: both the XL 9.1 concrete block making machine and the



*Efficient handling of layers by means of the Masa Cuboter*

Cuboter could be seen in action and demonstrated their potential on spot.

**Masa Splitter 1250**

The latest version of the “big” Masa Splitter with a maximum splitting width of 1,250 mm was well worth seeing even in the disconnected state. The splitter consists of a stable frame construction and a flexibly-mounted splitting unit. Thanks to the special mounting of the splitting unit there are many adjustment options, allowing optimum adaptation to the product. Thanks to the product-related adjustment options, ideal splitting results are achieved in terms of the fracture behaviour and the breaking force to be applied.



*The new version of the Masa Splitter impresses with an optimum splitting result*

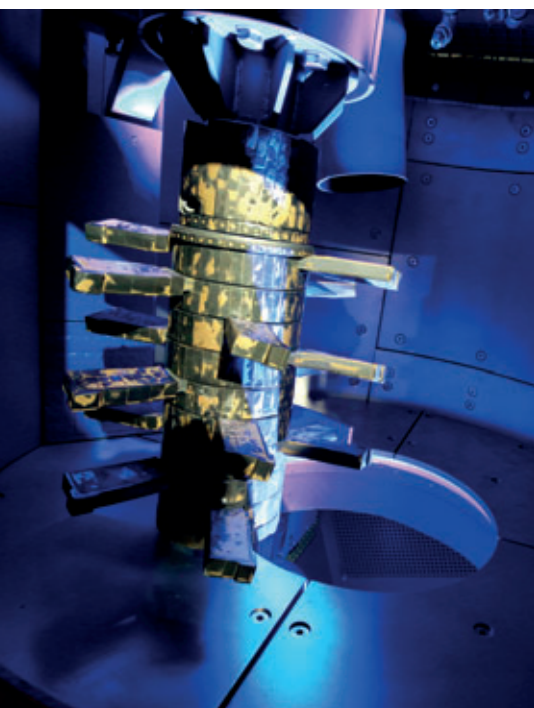

*A view inside the mixing trough with agitator*



*Visitors were able to see the new magnetic compaction head lock*

**Masa presented new camera system concept**

In addition to impressive machines, Masa also had on offer the concept of a new camera system. The current Masa remote maintenance hardware can be expanded by a certain number of high-definition cameras. The production process can be monitored and documented in video sequences, even over a longer period. Remote plant components such as mixers or the delivery of raw materials can be directly monitored from the control station via cameras. For the plant operator this means a considerable saving of walking distances and time. Convenient for the customers: Masa can deliver a complete package, so that no other further devices are needed.

However, the new Masa concept features more than that: the live integration of Masa F-E-S Support is possible via an encrypted high-speed data connection via Redbox. The operator is given even greater flexibility and mobility through the use of his own Smartphone or tablet. Using the camera

function, plant sections can be individually filmed, viewed live and recorded via integrated WLAN hotspots. Depending on the transmission rate, the sequence can then be made available to Masa Service either directly as a live stream or as a saved video file and provides for a further enhancement of the communication between customers and MASA Service. ■



Masa Support - fast and uncomplicated via your Smartphone



Masa sponsored the free download possibility of the pdf of this article for all readers of CPI. Please check the website [www.cpi-worldwide.com/channels/masa](http://www.cpi-worldwide.com/channels/masa) or scan the QR code with your smartphone to get direct access to this website.



FURTHER INFORMATION

**masa**

Milestone to your success.

Masa GmbH  
Masa-Straße 2  
56626 Andernach, Germany  
T +49 2632 92920  
F +49 2632 929212  
[info@masa-group.com](mailto:info@masa-group.com)  
[www.masa-group.com](http://www.masa-group.com)

# QUADRIX

**CONTROLLED CONCRETE CURING  
FOR HIGH QUALITY PAVERS, ROOF  
TILES, BLOCK AND MASONRY UNITS**

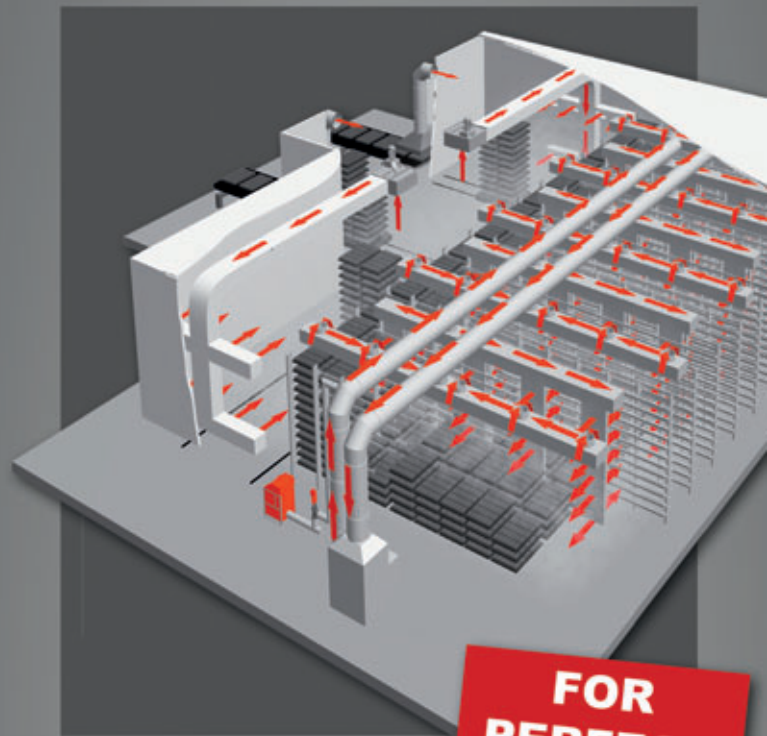

**FOR  
PERFECT  
RESULTS**



- ▶ Uniform, bright colors
- ▶ Denser surface, harder corners & edges
- ▶ High early strength
- ▶ Reduce cement costs
- ▶ Reduce efflorescence



Learn more by visiting  
[www.kraftcuring.com](http://www.kraftcuring.com)  
or scanning the QR code

**KRAFT CURING**

CONCRETE CURING SOLUTIONS · MADE IN GERMANY

Kraft Curing Systems GmbH  
49699 Lindern, Germany  
Phone: +49-5957-961260

Kraft Curing Systems, Inc.  
Fairless Hills, PA 19030, USA  
Phone: +1-267-793-1005

[www.kraftcuring.com](http://www.kraftcuring.com) · [info@kraftcuring.com](mailto:info@kraftcuring.com)